

10cm*15cm

Features:

1. Control the opening position of the door. Stop the door from closing suddenly and causing harm to children;
2. Prevent children from playing a trick and locking themselves in the room .

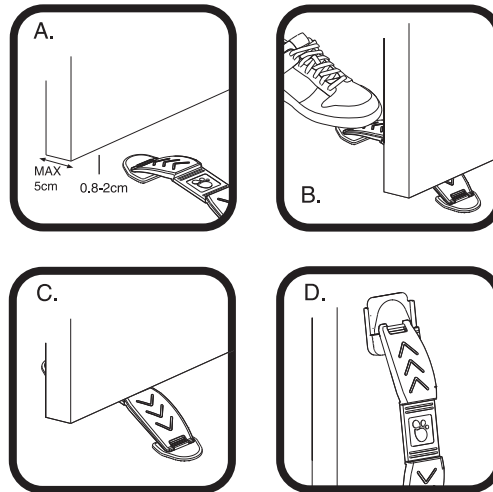

Installation Method

1. Put the product in the proper position on the floor;
2. Press the product to the minimum height with feet , and pull the door to the sunken place ;
3. Put the product on the hook when not in use.

WARNING!

- Please do not use the product for other purposes.
- The product can not substitute for adults and perform supervision on children.
- Please stop using in case of damage to the product.
- Assembly by an adult.